

Extended response

wall panel mounting system

FLAT RESPONSE SERIES

DESCRIPTION

The *Extended Response* wall mounting system allows the performance of wall-mounted acoustical absorption to be enhanced with minimal installation effort, by moving the absorptive acoustical core a distance away from the wall surface. By creating an air cavity between the acoustical panel and the wall, the low-frequency performance of the absorber is enhanced, equalizing the spectrum of absorption. This contributes to a more balanced, natural sound with tight bass response, free from “mushy” or “boomy” sound.

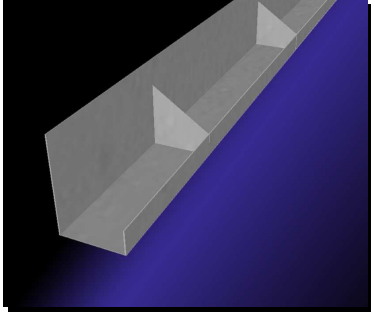

Extended Response mounting rails are simple to install, and require minimal field-adjustments and effort. Panels simply clip onto the hanging rails with Z-Clip fasteners.

APPLICATIONS

The *Extended Response* system finds applications in:

- Performing arts centers
- Houses of Worship
- Theatres and auditoriums
- Recording and post-production facilities
- Gymnasiums and gymnasium

PHYSICAL DATA

Dimensions	4" cavity depth x 8' length custom sizes available
Material	Steel
Panel Compatibility	WAVE FRSWP and ISWP panels with Z-Clip mounting hardware
Safety	Class A fire rating per ASTM E84

AVAILABLE OPTIONS

- Angled side, bottom, and top returns
- Side end-panels in matching fabric or wood trim
- Panel leveling edge for visually-perfect installation

ORDERING INFORMATION

4"x8' mounting rail	FRSHR-4-8
4"x8' mounting rail with leveling edge	FRSHR-4-8L
Splice plate (for connecting adjacent panels)	FRSHR-HP
End mount (for connecting side end-panels)	FRSHR-EM

* Call for custom configurations and options

TYPICAL APPLICATION

